

OFFICE FOR LEASE AVAILABLE NOW

Pacific Corporate Center

15688 SW 72nd Ave, Tigard, OR 97224
Building A



Key Features



1,824 sq. ft. office
2,580 sq. ft.

Large private offices

Two restrooms

End cap with great exposure
at intersection

Updated finishes and
landscaping

Immediate access to I-5

Walkable environment offering
a variety of amenities including
Starbucks and Gold's Gym

Lease Rate:

\$21.00/sq. ft.
NNN

Jake Bigby
jakeb@pactrust.com

Caitlin Knecht
caitlink@pactrust.com

503.624.6300

Owned & Managed by

PACTRUST

OFFICE FOR LEASE AVAILABLE NOW

Owned & Managed by

PACTRUST

Space Plan

15688 SW 72nd Ave, Tigard, OR 97224

2,580 Sq. Ft.

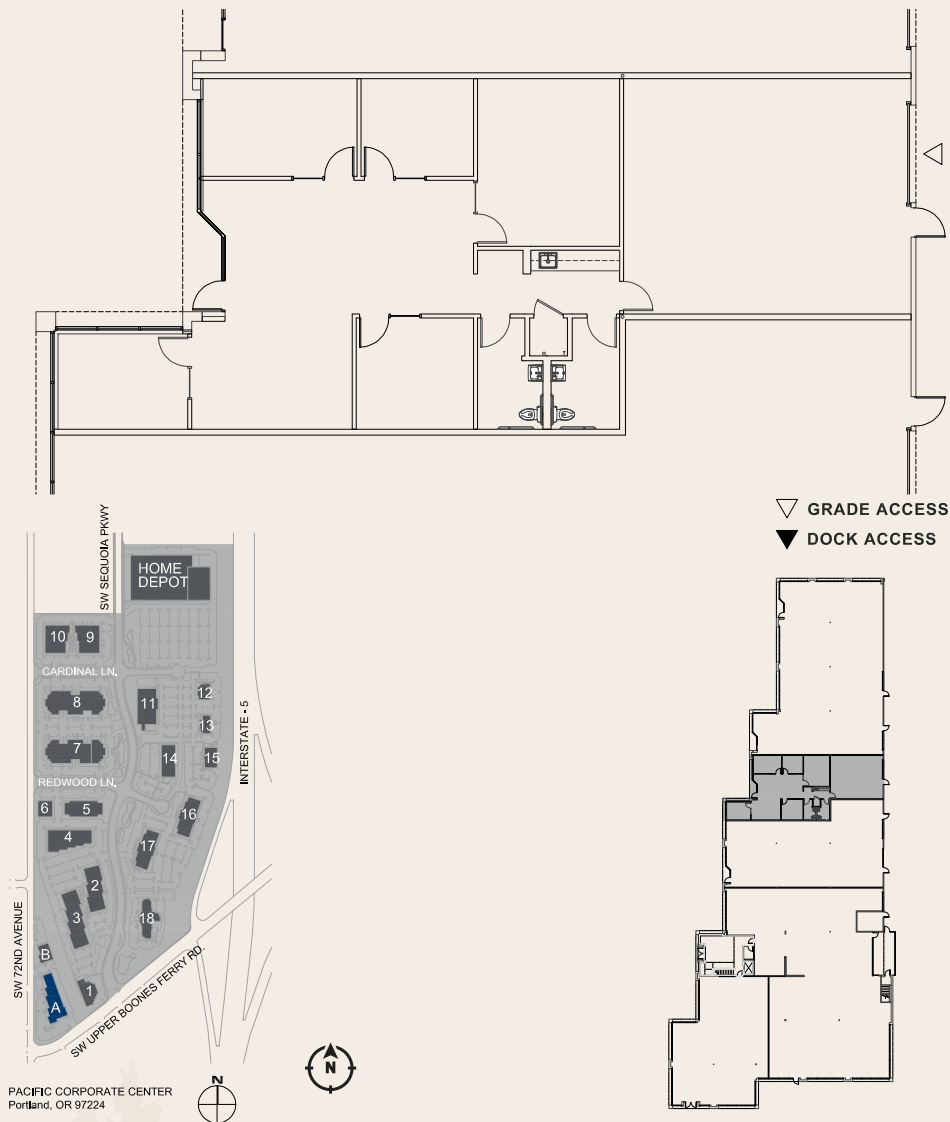

Jake Bigby

jakeb@pactrust.com

Caitlin Knecht

caitlink@pactrust.com

503.624.6300

www.PacTrust.com